



Get the most from TRADA membership



TRADA Members are entitled to a wide range of technical and marketing benefits.

Use this quick reference guide to check the benefits you are entitled to and how to get more information about them.

Benefits

TRADA - what it is and how it operates

TRADA (the Timber Research and Development Association) is an internationally recognised centre of excellence serving the timber and woodworking industries, their suppliers and customers. It is a not-for-profit, membership-based organisation and is managed by an independently elected Board of Directors, whose primary role is to support its membership's needs and enhance its reputation through the careful application of TRADA's resources.

Through TRADA's unique relationship with its sole appointed service provider, TRADA Technology Ltd, members are assured that all membership subscription revenues are applied to programmes of information and research. TRADA employs no staff. Projects can attract a proportion of other third-party funding, which ensures that the value of the programme exceeds the membership income spent in any one year.

TRADA Technology manages all aspects of membership administration including collecting subscriptions, issuing regular mailings and handling all enquiries from existing or potential members. It is also very active in maintaining liaison with other industry bodies and arranging a programme of workshops and seminars - aimed in particular at the Continuing Professional Development (CPD) of design professionals.

The telephone advisory helpline works hand in hand by TRADA's website, a unique web based Knowledge Resource that provides round-the-clock access to TRADA's wealth of technical information online. It is a complete, interactive resource covering all aspects of timber design, specification and use and will make every project involving timber easier and faster to deliver.

Key features include a searchable species guide, a construction drawing library of common details and a download area containing design software tools to assist the designer and a case study area. There is an online bookshop and a suppliers' directory which allows all visitors to the site to identify TRADA members who can supply the products they want to specify and use.

TRADA members are also eligible for discounts on all publications and selected training courses offered by TRADA Technology and its sister companies. These comprise BM TRADA Certification, Chiltern International Fire, Chiltern Dynamics and FIRA International - all part of the BM TRADA Group.

Discounts on exhibiting and attending TRADA events

TRADA's flagship event, Timber Expo, is a must event for anyone selling or specifying timber. This two day event, held each September at the Coventry Ricoh Arena, is now alongside TRADA's prime specifier conference 'In Touch with Timber'.

We run regional seminars throughout the year which are free for members on a range of topics designed to appeal to our broad membership base.

We also run a range of commercial training courses, on topics such as Timber Frame, Timber Grading, Fire Doors and Management Systems. TRADA members receive discounts on all of these courses.

How do I use this benefit?

TIMBER EXPO



To find out more about taking a stand at Timber Expo contact Loretta Sales,

Events Director on

t 0208 870 8794

m 07956173351

e loretta.sales@timber-expo.co.uk

w www.timber-expo.co.uk

For all training events and regional seminars please look out for details in the quarterly magazine, fortnightly enews and our website.

For further information on TRADA, please contact us on +44 (0) 1494 569603 or email membership@trada.co.uk

Sales enquiries from the TRADA website

Every month the TRADA website receives around 41,000 visits and delivers 55,000 pages of supplier information from the Suppliers Directory.

As the UK's most comprehensive listing of companies supplying timber related products and professional services it is very important to be listed.

Did you know the Suppliers Directory can now display your product catalogues?

This new feature enables members to add product brochures to their company information in the Suppliers Directory. With this free service you can upload your brochures via our website. Because they are indexed by our search engine, they appear in relevant site search results - providing another way of finding potential customers.

How do I use this benefit?

You can easily maintain your own directory entries by visiting www.trada.co.uk/membership and following the 'My Company Directory Listing' link.

For security reasons you will need an administrator's password – if you do not have one then please contact our membership administrator.

t +44 (0) 1494 569603

e membership@trada.co.uk

If you prefer we would be happy to update your record for you. Again, contact our membership administrator for details.

If you are having any trouble uploading your brochures please email them to membership@trada.co.uk.

If you would like to advertise in the Suppliers Directory please contact our media partner, Open Box Publishing Ltd
t +44 (0) 121 608 2300

Free entries in TRADA's Timber Industry Yearbook



The TRADA Timber Industry Yearbook is an annual printed publication distributed free-of-charge to 5,000 specifiers and manufacturers. Content includes both editorial and reference material, including a directory of suppliers.

As well as receiving copies for your own use, you are also entitled to free entries in up to five product or service categories in the Buyers Guide, with the opportunity to buy page advertising.

How do I use this benefit?

You can easily maintain your own directory entries by visiting www.trada.co.uk/membership and following the 'my company Yearbook Listing' link. If you have identified an error in your entry or have any other query about your directory entry, please contact our membership administrator.

t +44 (0) 1494 569603

e membership@trada.co.uk

If you are interested in advertising in the Yearbook please contact our media partner, Open Box Publishing Ltd
t +44 (0) 121 608 2300

Use the TRADA member logo on your stationery



As a member you are entitled to display the TRADA Member logo on your stationery, websites and marketing materials - subject to terms of use.

How do I use this benefit?

To request the artwork go to www.trada.co.uk/membership or contact our membership department.

t +44 (0) 1494 569603

e membership@trada.co.uk

Free expert telephone advice call +44 (0) 1494 569601



The TRADA telephone advisory line gives fast solutions to members' technical questions and, if necessary, free access¹ to TRADA Technology's expert consultants, subject to a maximum of 30 minutes per enquiry. Advice on a chargeable consultancy basis is available for projects requiring greater input.

How do I use this benefit?

If you or your staff have a question you need answering quickly, then contact the helpline on **t** +44 (0) 1494 569601 between 09.00 and 17.00hrs Monday-Friday (an answerphone operates outside these times). Alternatively you can email us. **e** advisory@trada.co.uk.

Access the latest TRADA technical information on line

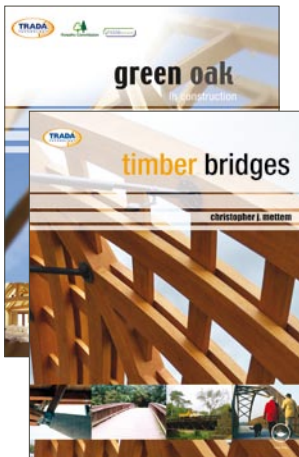

The full text of the most recent TRADA publications is available online for free viewing, exclusively to TRADA members. Bestselling titles accessible online include *Timber frame construction 4th Edition*, *Green oak in construction*, *Timber decking and External timber cladding*.

More than 300 documents from a variety of publishers are now available in the online technical library for reference.

How do I use this benefit?

Visit the 'Technical information' area of the website and select the 'Library' link, and then use the search facility to find the information you require.

Alternatively follow the links provided to read the text of specific books.

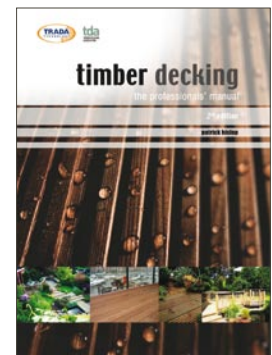
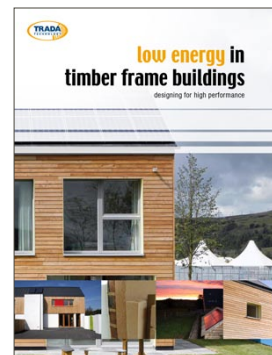

Detail drawings

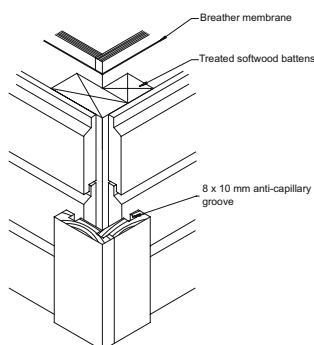

Best practice details reproduced from a range of TRADA publications and presented here as an easy reference collection. These include *External timber cladding*, *Timber decking*, *Standard details for Thermal Performance and Timber frame construction 4th edition*.

Each drawing is provided in both JPEG and PDF format².

How do I use this benefit?

Visit the 'Technical information' area of the website, select the 'Detail Drawings' link, then choose the category you require.

You must be signed in as a member to download the detail drawings. If you have misplaced your login details please use the 'forgotten your password?' link on the login page.

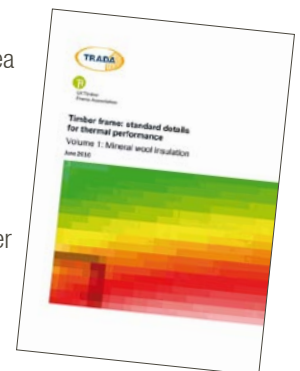

¹ Excludes written advice, for which minimum charges apply.

² You are permitted to use the drawings for internal use only. If you wish to republish them in any way, including on a website, then specific permission must be obtained from TRADA.

Wood Information Sheets



Members can download all current TRADA Wood Information Sheets (WIS's) free of charge from the TRADA website.

How do I use this benefit?

Visit either the Library or the Bookshop areas of the website and use the search facility to locate the sheet you require.

Additional printed copies are available at discounted members prices. Please contact:

t +44 (0) 1494 569602

e publications@trada.co.uk

Inspirational case studies and timber solutions



Case studies feature inspirational timber buildings selected for their quality in design and construction. Each study demonstrates why timber was selected and how the design works, including a comprehensive technical description and detail drawings.

TRADA members' involvement is highlighted, whether in the design or supply of materials.

Timber Solutions focus on specific building elements and show how common design challenges have been successfully addressed in timber.

How do I use this benefit?

Visit the 'Case Studies' area of the website for a list of all available Case Studies and Timber Solutions and follow the links for more information.

You must be signed in as a member to download the case study documents, including the architectural detail drawings. If you have misplaced your login details please use the 'forgotten your password?' link on the login page.

Please contact membership.

t +44 (0) 1494 569603

e membership@trada.co.uk

Up to 50% discount on books and British Standards

TRADA members are entitled to discounts of 10% off all British Standards and up to 50% off TRADA publications and other publishers in the bookshop. We also offer bulk discounts on TRADA publications.

Dedicated British Standards section

To ensure that everything is at your fingertips, we publish a list of regularly updated British Standards relevant to timber.

Customise TRADA books with your brand

As well as bulk discounts we can create special branded editions of our recent bestsellers, or produce more customised editions for members' own use. These make ideal sales promotion tools, corporate gifts or training materials³.

How do I use this benefit?

All our books and the most popular standards can be ordered online at www.trada.co.uk/bookshop. Alternatively to discuss your requirements and place your order contact our publications team.

t +44 (0) 1494 569602

e publications@trada.co.uk

To discuss any bespoke use of TRADA information please contact Jacquie Shanahan.

t +44 (0) 1494 569648

e jshanahan@trada.co.uk

3 Normally subject to a minimum order quantity.

Online CPD tracking

A CPD tracking device is available to enable you to keep a log of the number of articles you have read on the site. The system simply records the number of articles you have viewed within a given timeframe. You can print a certificate at any time showing the CPD points accrued.

How do I use this benefit?

Ensure you are signed in as a member then visit the 'Membership' page and click the 'My CPD' button. The first time you visit this area you need to enable CPD tracking. When you subsequently visit the system will show the number of CPD points accrued by month, with a link to print your certificate.

You can disable CPD tracking at any time.

Eurocode 5 design software

Eurocode 5 design software

The new online edition of **timbersizer EC5** is a time-saving design tool for engineers, architects, builders and other construction professionals. It will help to ensure designs meet the requirements of Eurocode 5 (EC5), which replaced British Standard 5268, the code for timber structures, in 2010.

Based on TRADA calculations, **timbersizer EC5** covers all domestic structural timber members:

- Joists for domestic floors, ceilings or flat roofs
- Binders supporting ceiling joists
- Rafters
- Purlins supporting rafters, sheeting or decking.

timberconnections EC5 calculates the load capacity of individual fasteners based on timber strength classes C16 or C24. You can calculate connection capacities with nails, screws, bolts, dowels and coach screws in two and three member combinations of timber and steel.

timbersizer and **timberconnections** are free to all TRADA members.

timbersizerPro and timberconnectionsPro

This software is available on a subscription basis to members at a discounted rate.

Subscribers can customise and tweak all design parameters with advanced controls to define specific timber sizes and unload values for strength classes in the range C14-D70.

Both products generate custom reports in PDF format for records and Building Control purposes. These reports demonstrate where the design meets or fails to meet the requirements of Eurocode 5, and provide more detailed feedback for the user, including numerical strength / stress comparisons of timber performance.

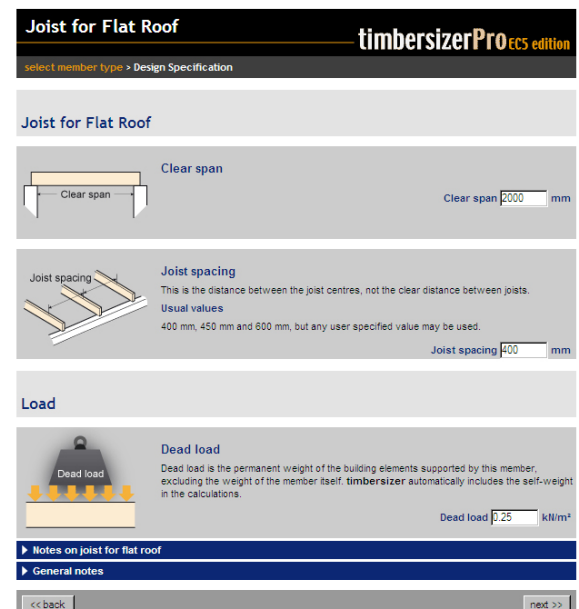

How do I use this benefit?

Visit the 'Technical information' area of the website and select the 'Design tools' link. Each program can be accessed from this page.

Users can access the online tool from a PC or MAC, whenever they choose. TRADA engineers maintain **timbersizer EC5** to ensure it always reflects the latest version of Eurocode 5.

Point of sale literature

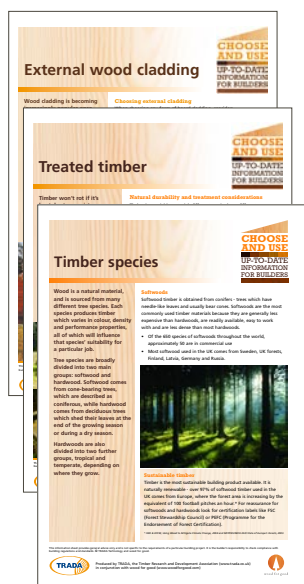

The 'Choose & Use' Point of sale (POS) literature, launched early in 2008, is available exclusively to members of TRADA. Based on market research among merchant members, the sheets have been designed to help merchants guide their customers in making the right choice of timber materials. A growing range of sheets are available for merchants to download and print.

The sheets incorporate an editable text box where you can add your company information before printing. You are encouraged to print copies and distribute them to your trade and retail customers.

How do I use this benefit?

Each sheet can be downloaded in a PDF format by visiting the 'Technical information' area of the website and selecting the 'Choose and Use Sheet' link.

If you would like us to print copies on your behalf, please contact Jacquie Shanahan to discuss your requirements.

t +44 (0) 1494 569648

e jsahanahan@trada.co.uk

You must be signed in as a member to download the Choose & Use sheets. If you have misplaced your login details please use the 'forgotten your password?' link on the login page.

Construction briefing sheets



These briefing sheets summarise the requirements of the main codes and regulations impacting construction. The briefings are regularly updated, with subjects including building regulations (England & Wales, Scotland and Northern Ireland), as well as the main codes such as the Code for Sustainable Homes (CSH), Eurocode 5 and Construction (Design & Management) (CDM) regulations.

How do I use this benefit?

Each sheet can be downloaded in a PDF format by visiting the 'Regulations & Codes' area of the website and following the links.

In-house briefings for senior management

We offer in-house briefings on topical subjects of strategic business relevance (e.g. developments in Regulations, Codes and Standards) to senior managers/directors of TRADA member companies. These are provided free of charge to companies in Timber Industry membership bands F, G and H, with a substantial discount to all other members.



How do I use this benefit?

Contact Rupert Scott.

t +44 (0) 1494 569817

e rscott@trada.co.uk

to discuss how we can tailor our briefings to your business and to book your event.

Become a member

Joining TRADA is very simple.

For specifiers and contractors you can join on-line at www.trada.co.uk/membership.

Alternatively downloadable forms for all membership categories are available at www.trada.co.uk/membership, or just contact our membership department.

t +44 (0) 1494 569603

e membership@trada.co.uk

We look forward to welcoming you into membership soon.

